

[NK] 3 copies of Preliminary General Arrangement drawings are to be submitted in accordance with Part B 2.1.2.5 of Guidelines for the Survey and Construction of Steel Ships

[NK] Approved in accordance with Merchant Shipping (Non-convention Ships) Safety Regulations of Singapore.

[NK] Approved subject to the relevant exemptions from company rules and regulations under LREG '72 as granted by the Flag Administration.

PRINCIPAL PARTICULARS

L.O.A.	32.100M (105.31FT)
L.B.P.	29.376M (96.38FT)
BREADTH MLD	9.000M (29.53FT)
DEPTH MLD	4.200M (13.78FT)
DESIGNED DRAFT	3.600M (11.81FT)
(SUBJECT TO FREEBOARD ASSIGNMENT)	
COMPLEMENT	15 MEN
SPEED	ABT 12 KNOTS
F.O. CAPACITY	201 TONS (APPROX.)
F.W. CAPACITY	22 TONS (APPROX.)
B.W. CAPACITY	31 TONS (APPROX.)
MAIN ENGINE	CUMMINS KTA50-M2 1600HP@1800RPM x 2 UNITS
GEAR BOX	RATIO 6.00:1
GENERATOR	78KW x 2 UNITS
HARBOUR GEN.SET	50KW x 1 UNIT
FLAG	SINGAPORE
NAVIGATION AREA	INTERNATIONAL

[NK] L by NK Rules: 27.613 mm

[NK] ds : 3.600 mm

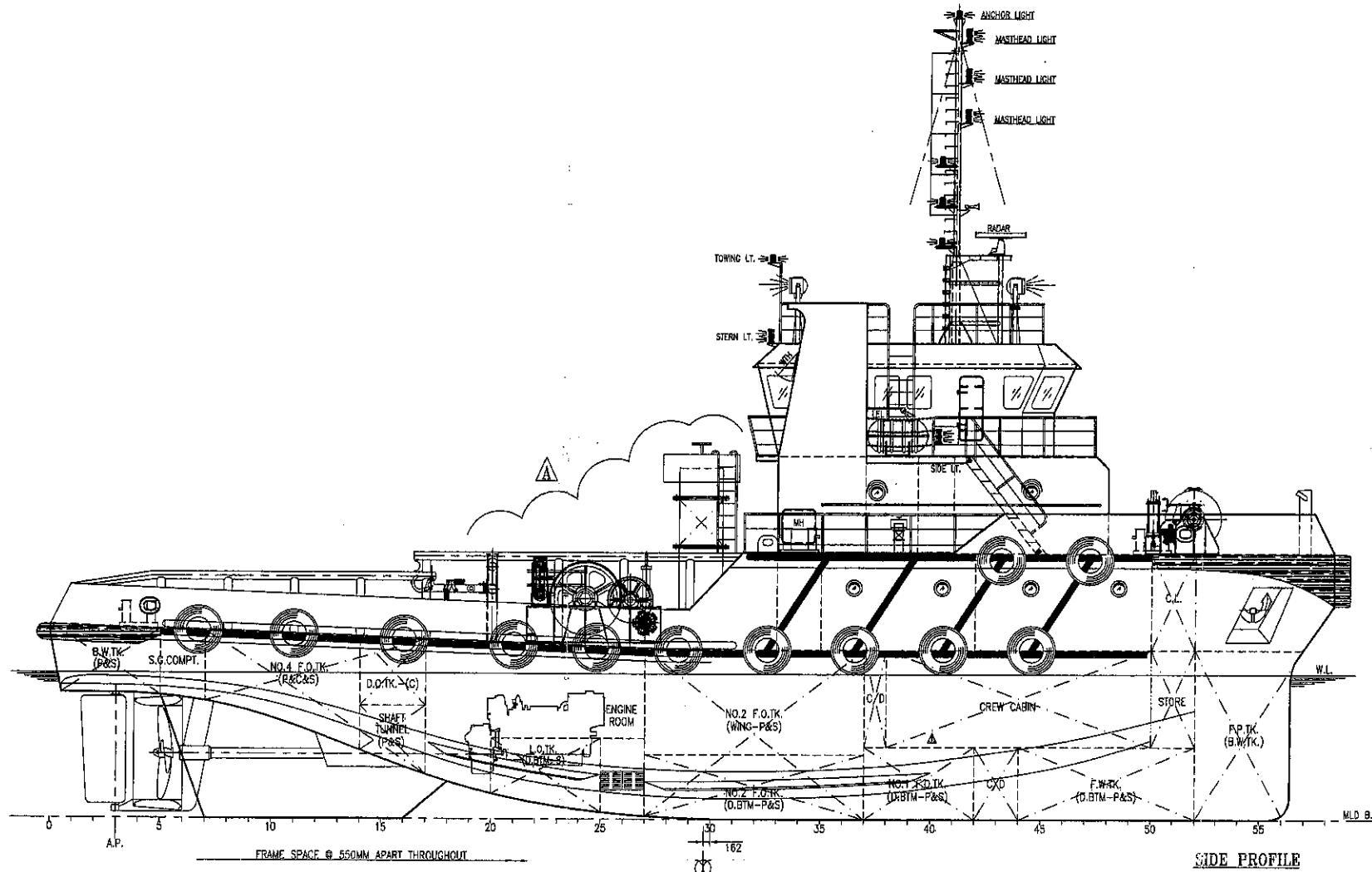

SIDE PROFILE

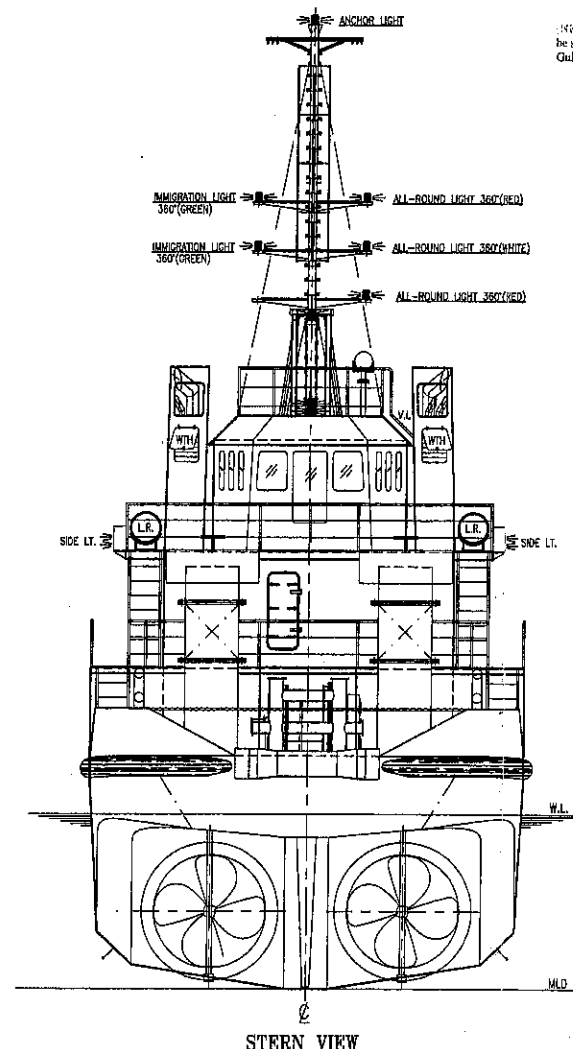

STERN VIEW

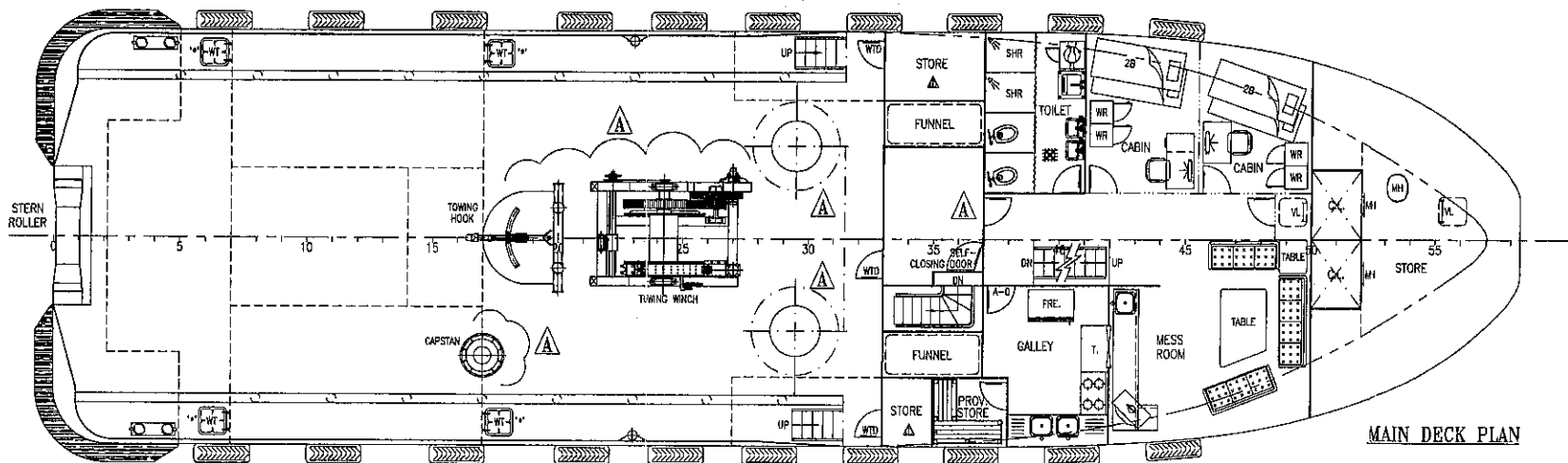

MAIN DECK PLAN

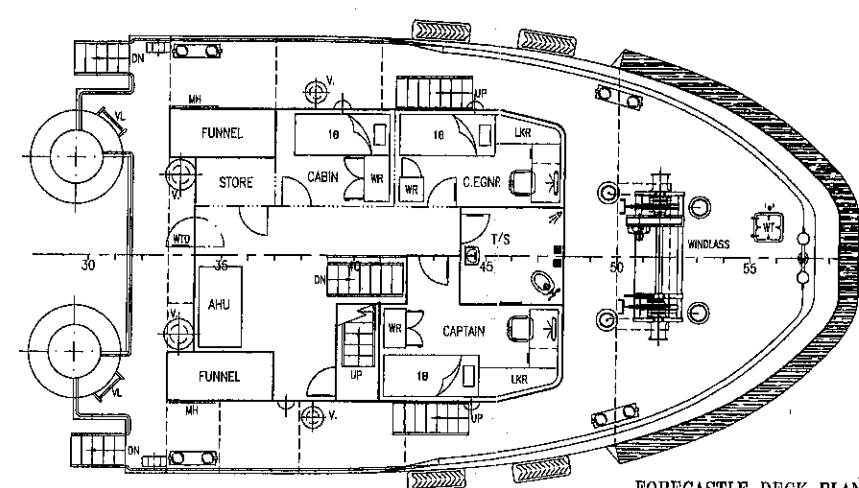

FORECASTLE DECK PLAN

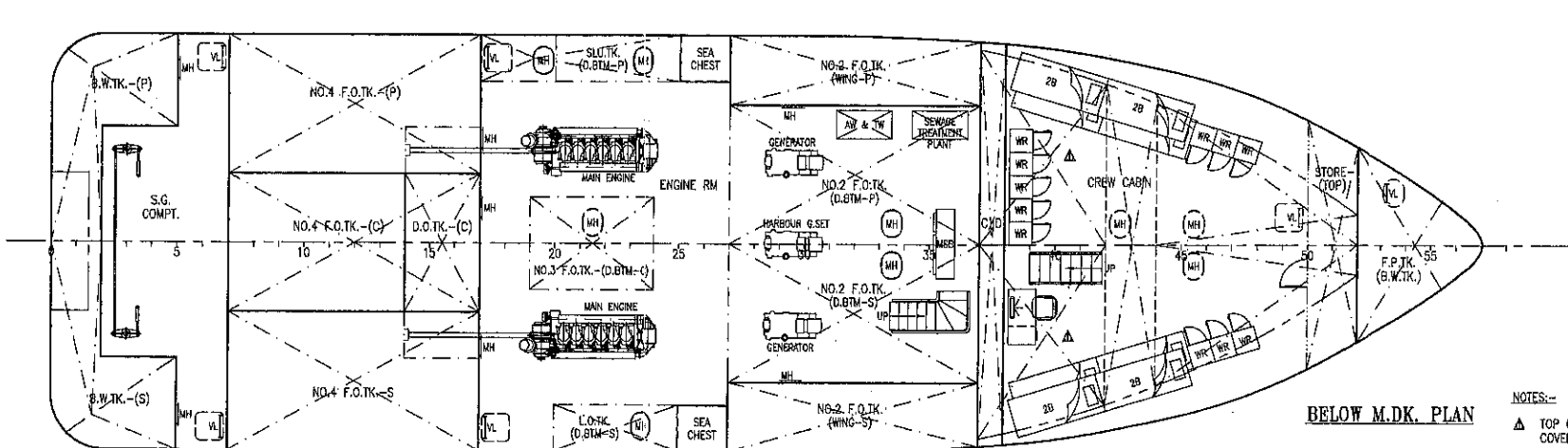

BELOW M.D.K. PLAN

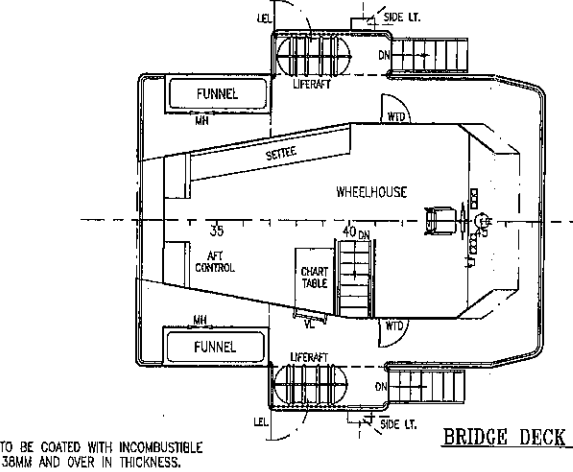

BRIDGE DECK PLAN

NOTES:-
 ▲ TOP OF F.O.T. TO BE COATED WITH INCOMBUSTIBLE COVERINGS OF 38MM AND OVER IN THICKNESS.
 WTD = WEATHER TIGHT DOOR
 WP* = TO BE NOTICE/SIGN "TO BE PERMANENTLY KEPT CLOSED AT THE SEA".



FOR APPROVAL

27.05.07	AMENDMENT AS PER OWNER REQUEST	A	
DATE	MODIFICATION	REV	BY
SHIP			
32M TWIN SCREW TUG			
TITLE			
GENERAL ARRANGEMENT			
OWNER			
BUILDER			
CLASS	NK		
DRAWN	CHECKED	APPROVED	SCALE
29.03.07	07.04.07		1 : 75
			DRAWING NO. US/321-61(A)